

NON-CORROSIVE TRANSFER PUMPS - S SERIES

FEATURES

- Non-corrosive plastic construction and stainless steel for components in contact with liquid
- Motor shaft is completely insulated from any contact with pumping liquid
- Phenolic/Ceramic mechanical shaft seal with nitrile elastomers and 18-8SS components
- Patented, air-cooled heat sink allows pump to run dry or in loss-of-prime conditions without damage to the shaft seal
- Unconditional two-year warranty against seal failure
- Floating eye seal on the impeller maximizes pump efficiency for best flow and pressure
- Accepts a standard 1-1/2" union (ordered separately) or a male 1-1/2" pipe thread
- UL and CSA agency listing applies to clean water applications only



ORDERING INFORMATION

Model	HP	Dis. x Suc. (MNPT)	Voltage	S.F.A.	Order No.	Wt. (lbs)
S7KM	3/4	1-1/2" x 1-1/2"	115	9.8	94028263	22
S1KM	1		115	9.8	94028271	24
S15KM	1-1/2		115	12.4	94028289	26
S2M	2		115/230	16/8	94028297	35
Fittings kit contains (2) 1-1/2" slip x threaded connection union halves					31175608	1

NOTE: Set of union halves must be purchased separately

DIMENSIONS

Model	HP	A	C
S7KM	3/4	14.19"	7.19"
S1KM	1	14.19"	7.19"
S15KM	1-1/2	15.13"	7.69"
S2M	2	15.13"	7.13"

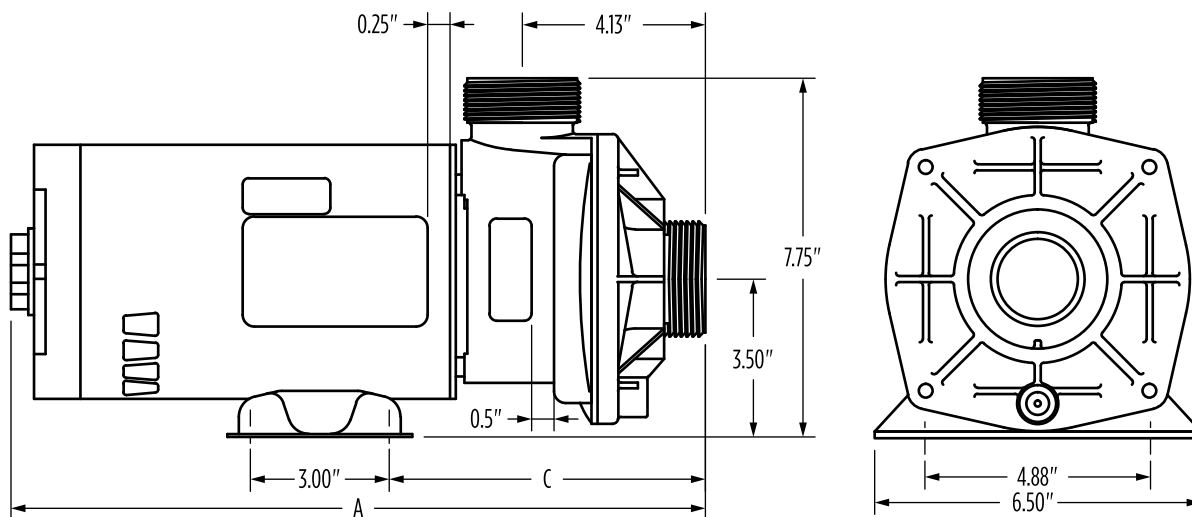

NON-CORROSIVE TRANSFER PUMPS - S SERIES

PERFORMANCE

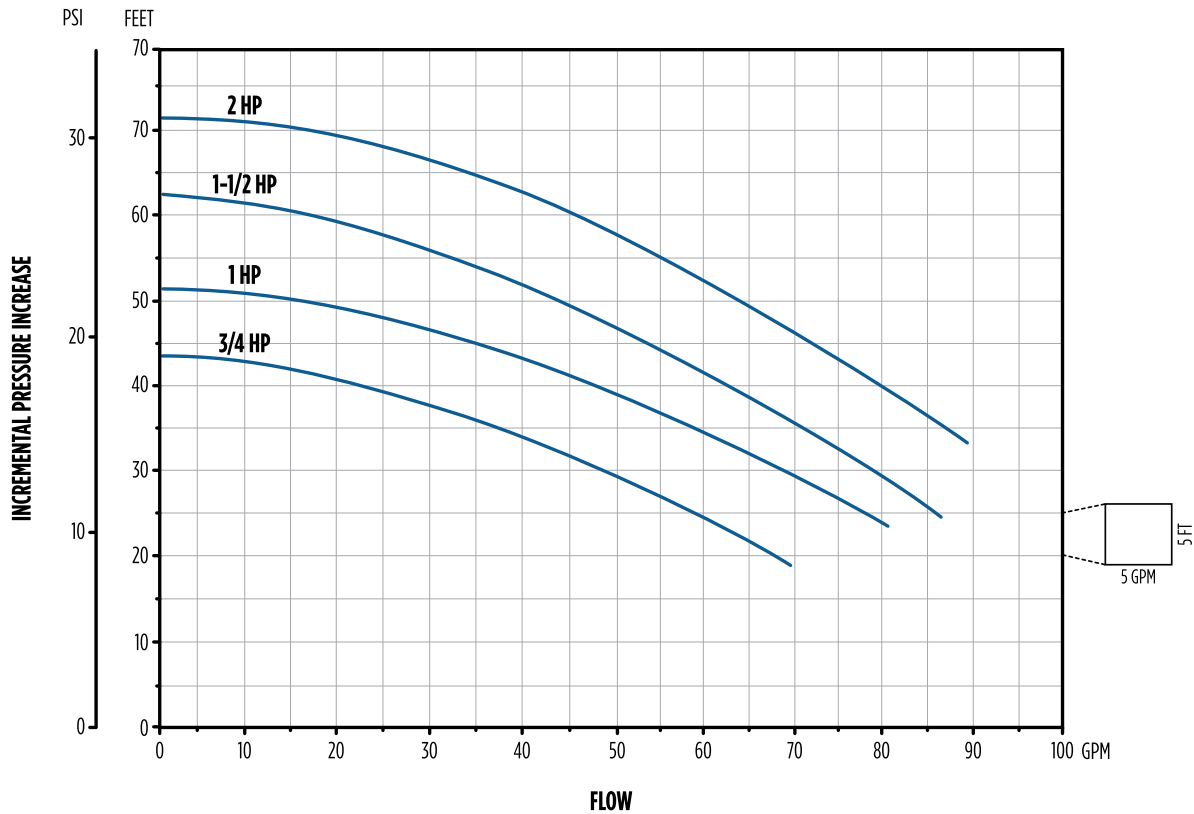

Model	HP	Total Head (ft)						Shut-off Head (ft)
		20	30	40	50	60	70	
S7KM	3/4	68.0	48.0	21.0	-	-	-	43
S1KM	1	-	69.0	47.0	16.0	-	-	51
S15KM	1-1/2	-	79.0	62.0	42.0	66.0	-	62
S2M	2	-	-	80.0	62.0	45.0	17.0	72