

## End Suction Pumps

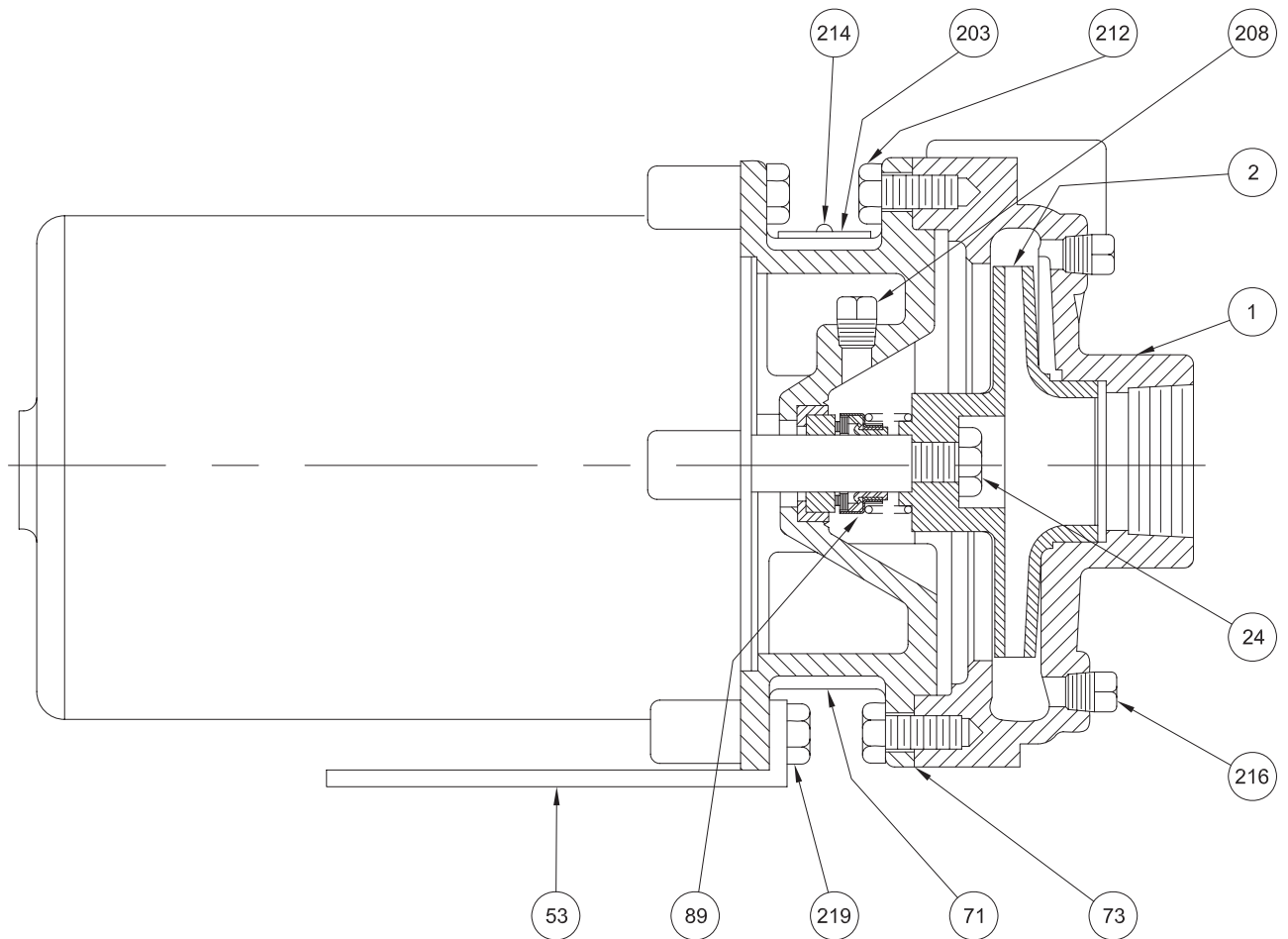

ITEM No.	DESCRIPTION
001	Casing
002	Impeller
024	Impeller Nut
053	Base
071	Adapter
*073	Casing Gasket
*089	Mechanical Seal

ITEM No.	DESCRIPTION
203	Nameplate
208	Pipe Plug
212	Cap Screw
214	Drive Screw
216	Pipe PLug
219	Cap Screw

(+) Furnish ONLY in pairs as complete unit

(\*) For Domestic Service we recommend these parts be carried in stock as spares

(±) Double Wearing Rings furnished as special equipment ONLY.