

Submersible Grinder Pumps

| | |
|---------------------------------|--|
| DISCHARGE | 1¼" NPT, Female, Vertical, Bolt-On Flange |
| LIQUID TEMPERATURE | 160°F (71°C) Intermittent |
| VOLUTE | Cast Iron ASTM A-48, Class 30 |
| MOTOR HOUSING | Cast Iron ASTM A-48, Class 30 |
| SEAL PLATE | Cast Iron ASTM A-48, Class 30 |
| LEGS | Removable and Adjustable |
| IMPELLERS: Design | 12 Vane, Vortex, With Pump Out Vanes On Back Side. Dynamically Balanced, ISO G6.3. |
| <i>Material</i> | Cast Iron ASTM A-48, Class 30 |
| SHREDDING RING | Hardened 440C Stainless Steel, Rockwell® C-55. |
| CUTTER | Hardened 440C Stainless Steel, Rockwell® C-55. |
| SHAFT | 416 Stainless Steel |
| SQUARE RINGS | Buna-N |
| HARDWARE | 300 Series Stainless Steel |
| PAINT | Air Dry Enamel. |
| SEAL: | |
| <i>Design</i> | Single Mechanical |
| <i>Material</i> | Silicon-Carbide/Silicon-Carbide/Buna-N |
| | Hardware -300 Series Stainless |
| CORD ENTRY | 20 ft. (6m) Cord with plug Custom Molded Quick Connect, for Sealing and Strain Relief |
| UPPER BEARING | Single Row, Ball, Oil Lubricated |
| <i>Load</i> | Radial |
| LOWER BEARING | |
| <i>Load</i> | Single Row, Ball, Oil Lubricated Radial & Thrust |
| MOTOR: | |
| <i>Design</i> | NEMA L-Single Phase Torque Curve, Oil-Filled, Squirrel Cage Induction |
| <i>Insulation</i> | Class F |
| SINGLE PHASE | Capacitor Start/Capacitor Run. |
| LEVEL CONTROL: | |
| <i>A Series</i> | Pipe Mounted, Piggy-Back, Mechanical with 240 Plug |
| ACCESSORIES | Break Away Fitting (BAF) Check Valve Control Panel |

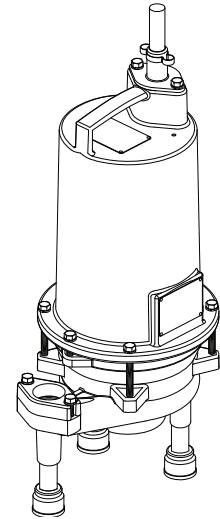

**Series: PGPP & PGPH,
ProGrind
2HP, 3450RPM, 60Hz**

DESCRIPTION:

THE GRINDER PUMP IS DESIGNED TO REDUCE DOMESTIC, COMMERCIAL, INSTITUTIONAL AND LIGHT INDUSTRIAL SEWAGE TO A FINELY GROUND SLURRY



WARNING:

CANCER AND REPRODUCTIVE HARM -
WWW.P65WARNINGS.CA.GOV



**TOTAL HEAD
METERS FEET**

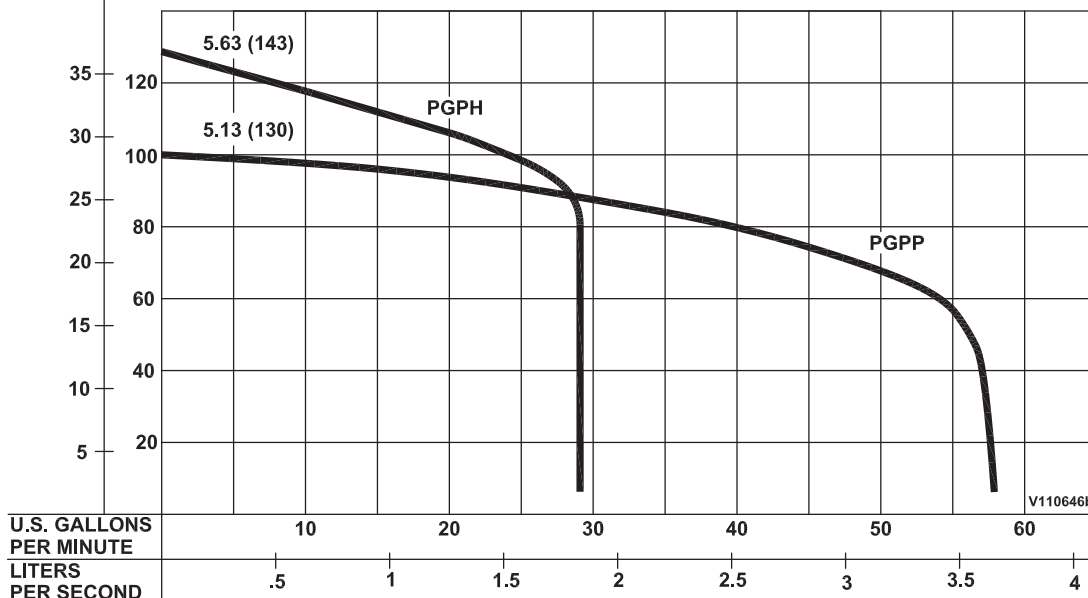

Testing is performed with water specific gravity of 1.0 @ 68°F (20°C), other fluids may vary performance

Series PGPP, PGPH

ProGrind, Vortex

BARNES®

Professional Plumbing

www.cranepumps.com

Submersible Grinder Pumps

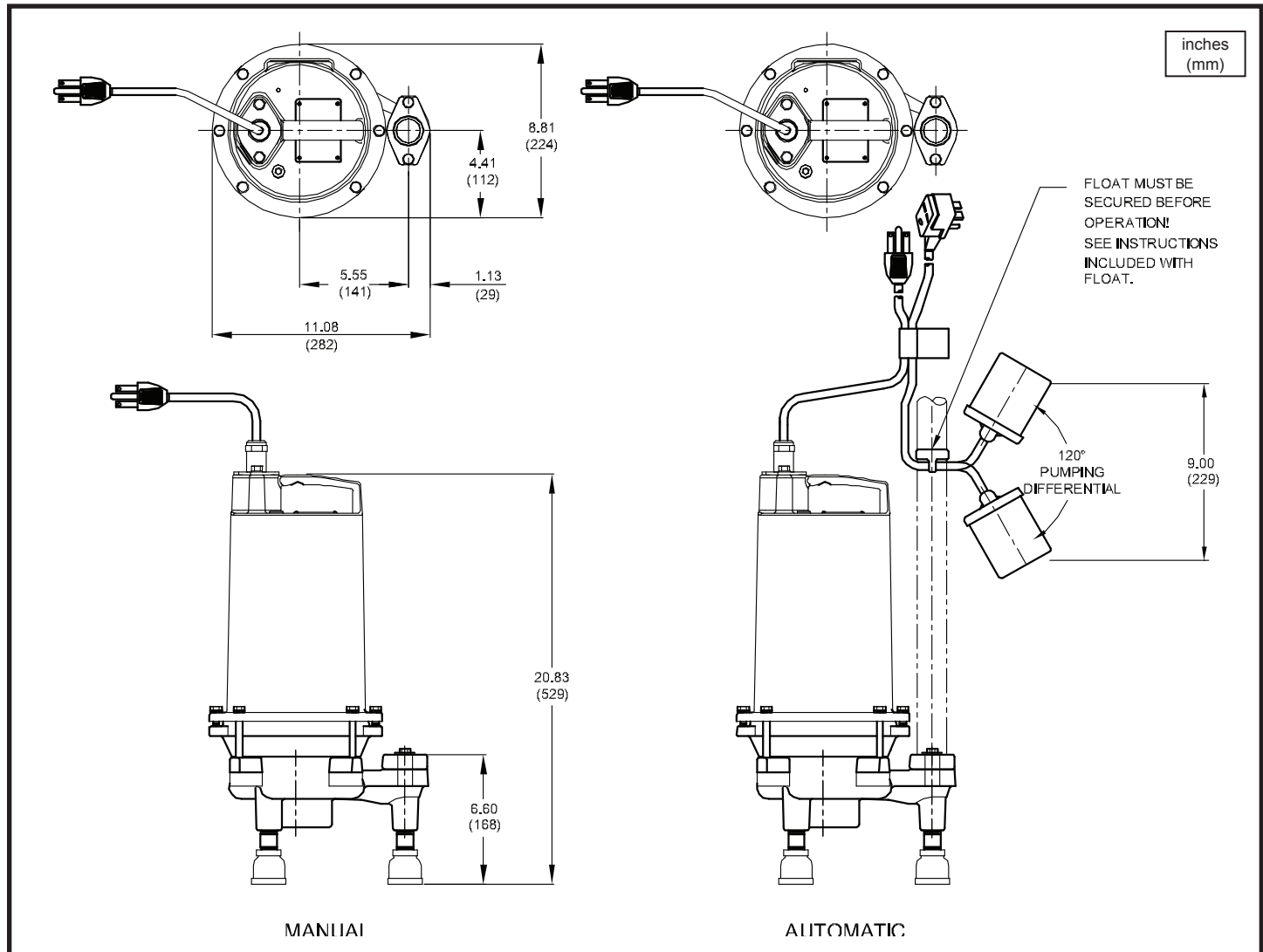

| MODEL NO | PART NO | HP | VOLT/PH | Hz | RPM (Nom) | NEMA START CODE | FULL LOAD AMPS | LOCKED ROTOR AMPS | CORD SIZE | CORD TYPE | CORD O.D. ± .02 (.5) inch (mm) |
|-----------|---------|----|---------|----|-----------|-----------------|----------------|-------------------|-----------|-----------|--------------------------------|
| PGPP2022 | 110646 | 2 | 240/1 | 60 | 3450 | H | 15.0 | 53.8 | 14/3 | SOW | 0.61 (15.5) |
| PGPP2022A | 112916 | 2 | 240/1 | 60 | 3450 | H | 15.0 | 53.8 | 14/3 | SOW | 0.61 (15.5) |
| PGPH2022 | 131467 | 2 | 240/1 | 60 | 3450 | H | 15.0 | 53.8 | 14/3 | SOW | 0.61 (15.5) |
| PGPH2022A | 131468 | 2 | 240/1 | 60 | 3450 | H | 15.0 | 53.8 | 14/3 | SOW | 0.61 (15.5) |

IMPORTANT !

- 1.) PUMP MAY BE OPERATED "DRY" FOR EXTENDED PERIODS WITHOUT DAMAGE TO MOTOR AND/OR SEALS.
- 2.) INSTALLATIONS SUCH AS DECORATIVE FOUNTAINS OR WATER FEATURES PROVIDED FOR VISUAL ENJOYMENT MUST BE INSTALLED IN ACCORDANCE WITH THE NATIONAL ELECTRIC CODE ANSI/NFPA 70 AND/OR THE AUTHORITY HAVING JURISDICTION. THIS PUMP IS NOT INTENDED FOR USE IN SWIMMING POOLS, RECREATIONAL WATER PARKS, OR INSTALLATIONS IN WHICH HUMAN CONTACT WITH PUMPED MEDIA IS A COMMON OCCURRENCE.

SECTION E
PAGE 10
DATE 3/14

CRANE®

A Crane Co. Company

PUMPS & SYSTEMS

USA: (937) 778-8947 • Canada: (905) 457-6223 • International: (937) 615-3598