

BP-HT – 1/3 HP

High Temperature - 3/4" Spherical Solids Handling - Manual & Automatic - Submersible

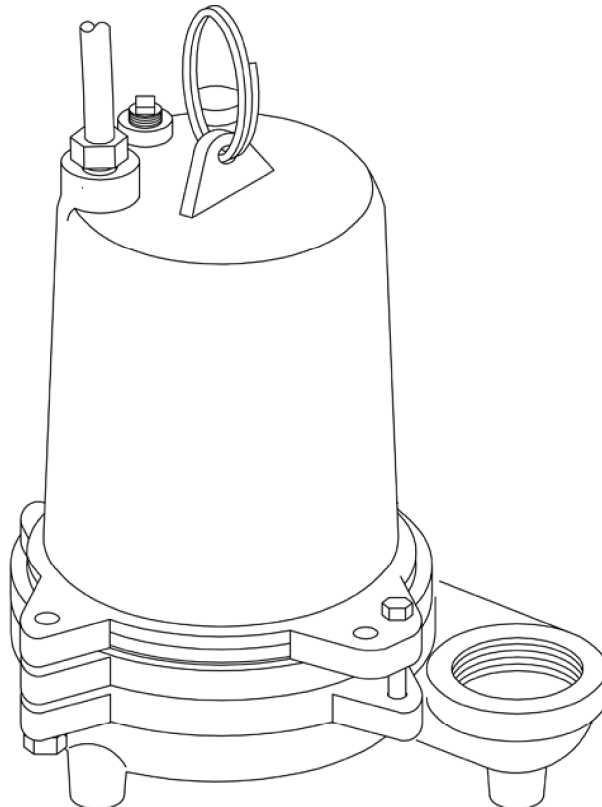

DISCHARGE:	2" NPT, Female, Vertical
LIQUID TEMPERATURE:	200°F (93°C) Continuous
VOLUTE:	<ul style="list-style-type: none"> • (BP): Cast Iron • (BP-BR): Bronze
MOTOR HOUSING:	<ul style="list-style-type: none"> • (BP): Cast Iron • (BP-BR): Bronze
SEAL PLATE:	<ul style="list-style-type: none"> • (BP): Cast Iron • (BP-BR): Bronze
IMPELLER:	<ul style="list-style-type: none"> • Design: 2 Vane open, dynamically balanced, ISO G6.3 • Material: Bronze 81-3-7-9
UPPER BEARING:	Single row ball, oil lubricated
LOWER BEARING:	Single row ball, oil lubricated
SEAL:	<ul style="list-style-type: none"> • Design: Single mechanical, oil filled reservoir, secondary exclusions seal • Material: Carbon/Ceramic/Buna-N
CORD ENTRY:	15 ft. (4.5m) Quick disconnect cord with plug On 115 volt, pressure grommet for sealing and strain relief
MOTOR:	<ul style="list-style-type: none"> • Single Phase: Permanent Split Capacitor (PSC). oil filled. Includes overload protection in motor • Insulation: Class B
LEVEL CONTROL:	<ul style="list-style-type: none"> • A: High temperature, wide angle, mechanical, N/O, 15 ft (5m) cord with Piggy-Back plug • AU: High temperature, wide angle, Polypropylene, mechanical, N/O integral to pump. ON and OFF points are adjustable

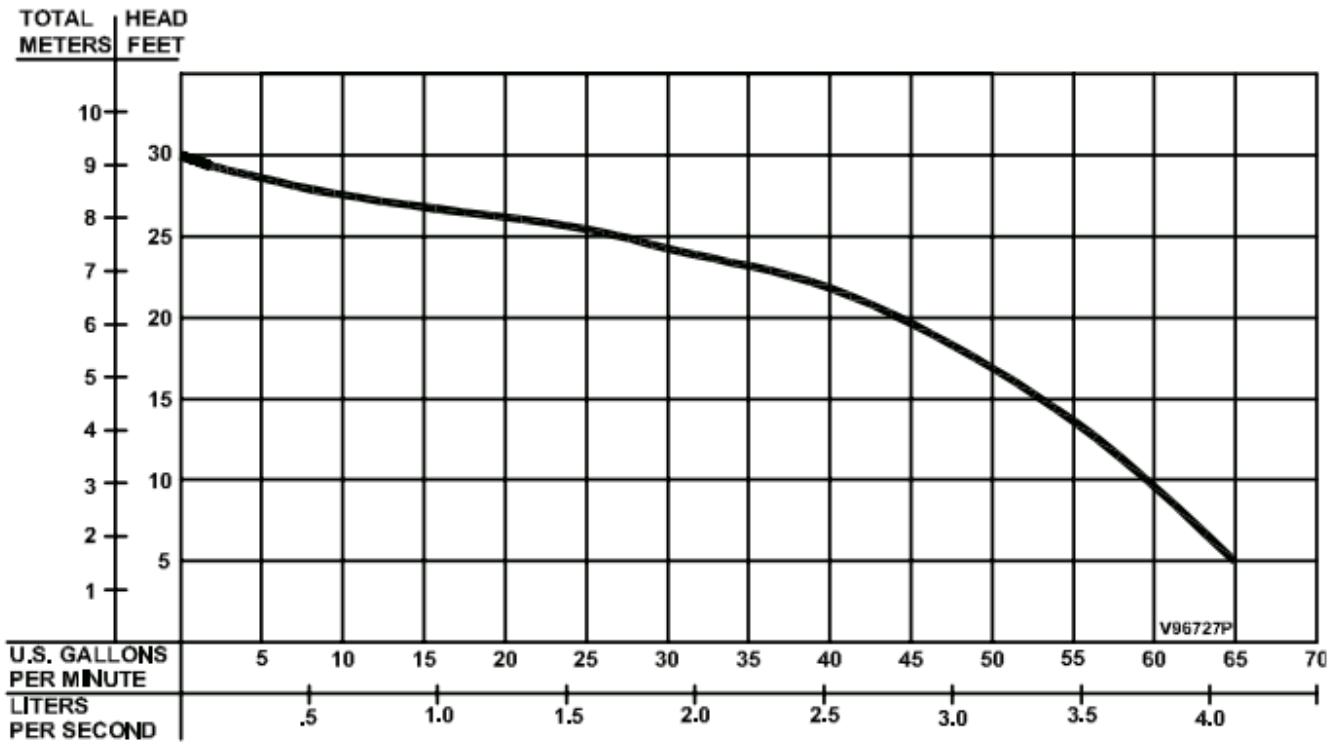

Testing is performed with water specific gravity of 1.0 @ 68°F (20°C), other fluids may vary performance

PUMP MODEL NUMBER	BP314HT	BP314HTA	BP314HTAU	BP314HTBR	BP314HTABR	BP314HTAUBR	BP324HT	BP324HTAU	BP324HTBR	BP324HTAUBR
PART NUMBER	096737	096738	096739	096742	096743	096744	096740	096741	096745	096746
HP	1/3	1/3	1/3	1/3	1/3	1/3	1/3	1/3	1/3	1/3
VOLTAGE/PHASE	115/1	115/1	115/1	115/1	115/1	115/1	230/1	230/1	230/1	230/1
HZ	60	60	60	60	60	60	60	60	60	60
RPM (NOMINAL)	1750	1750	1750	1750	1750	1750	1750	1750	1750	1750
NEMA START CODE	A	A	A	A	A	A	A	A	A	A
FULL LOAD AMPS	8.0	8.0	8.0	8.0	8.0	8.0	5.4	5.4	5.4	5.4
LOCKED ROTOR AMPS	19.0	19.0	19.0	19.0	19.0	19.0	13.0	13.0	13.0	13.0
CORD SIZE	14/3	14/3	14/3	14/3	14/3	14/3	14/3	14/3	14/3	14/3
CORD TYPE	SOOW	SOOW	SOOW	SOOW	SOOW	SOOW	SOOW	SOOW	SOOW	SOOW
WEIGHT (LBS)	52	53	52	53	53	53	52	53	53	53



IMPORTANT

- 1.) PUMP MAY BE OPERATED "DRY" FOR EXTENDED PERIODS WITHOUT DAMAGE TO MOTOR AND/OR SEALS.
- 2.) INSTALLATIONS SUCH AS DECORATIVE FOUNTAINS OR WATER FEATURES PROVIDED FOR VISUAL ENJOYMENT MUST BE INSTALLED IN ACCORDANCE WITH THE NATIONAL ELECTRIC CODE ANSI/NFPA 70 AND/OR THE AUTHORITY HAVING JURISDICTION. THIS PUMP IS NOT INTENDED FOR USE IN SWIMMING POOLS, RECREATIONAL WATER PARKS, OR INSTALLATIONS IN WHICH HUMAN CONTACT WITH PUMPED MEDIA IS A COMMON OCCURRENCE.

BP314HT, BP314HTBR, BP324HT, BP324HTBR

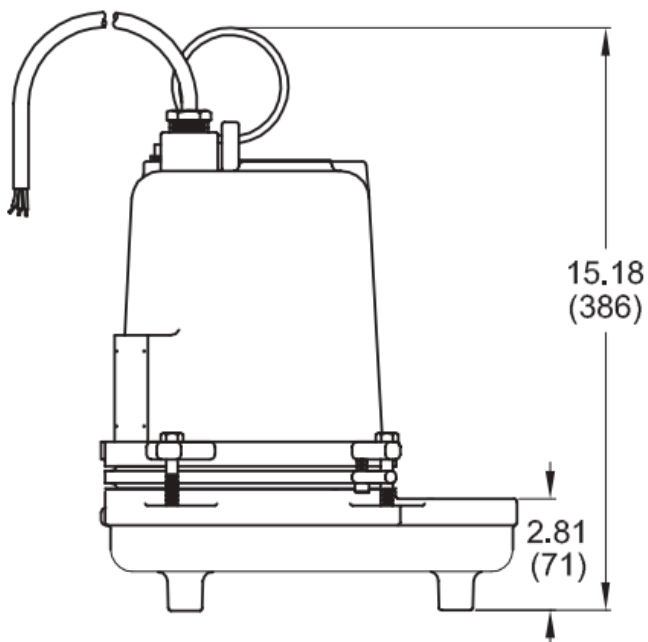
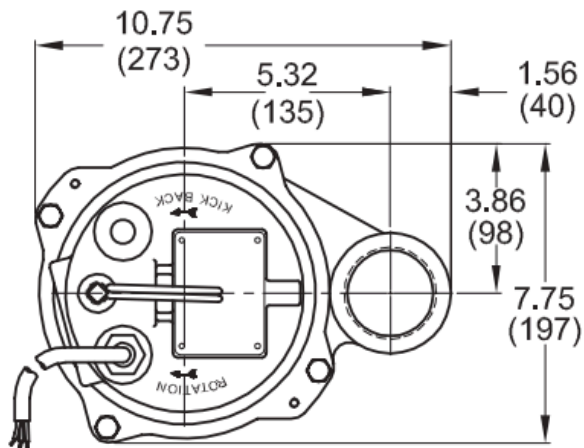

All dimensions are in inches (mm)

BP314HTA & BP314HTABR

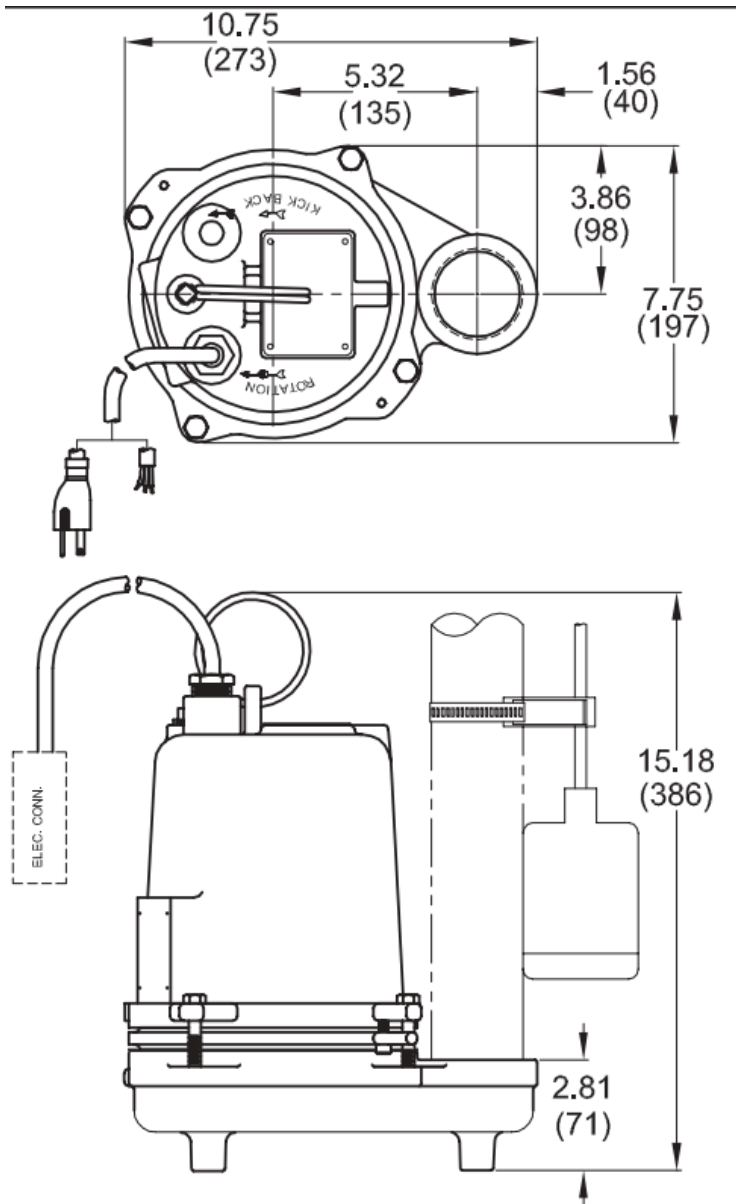

 All dimensions are in inches (mm)

BP314HTAU, BP314HTAUBR, BP324HTAU, BP324HTAUBR

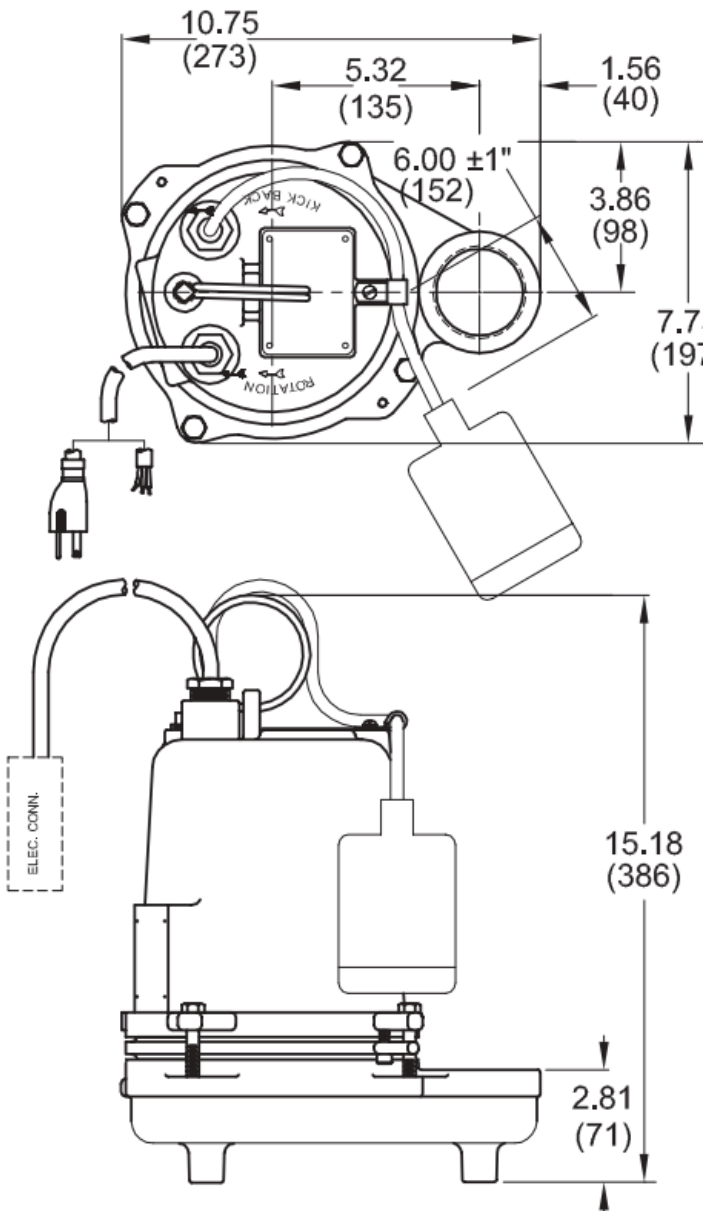

 All dimensions are in inches (mm)